

Schema di montaggio COLONNA reversibile GARDENIA

" POSIZIONAMENTO A TERRA "

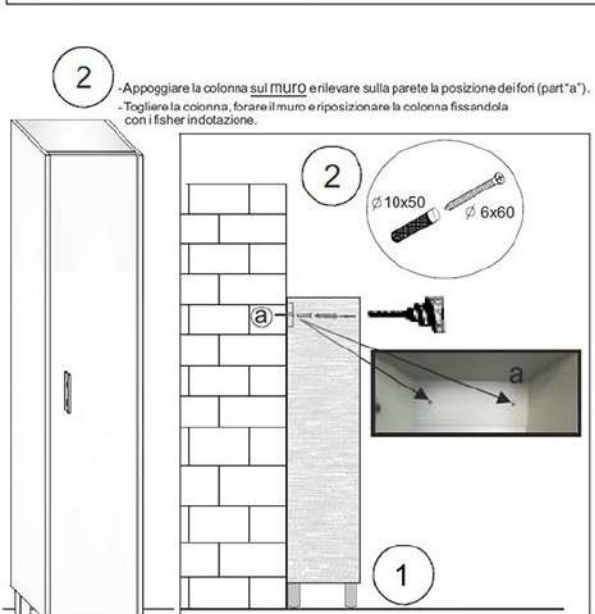

1 Montaggio piedini: Avvitare i piedi alla base, in corrispondenza fori presenti.

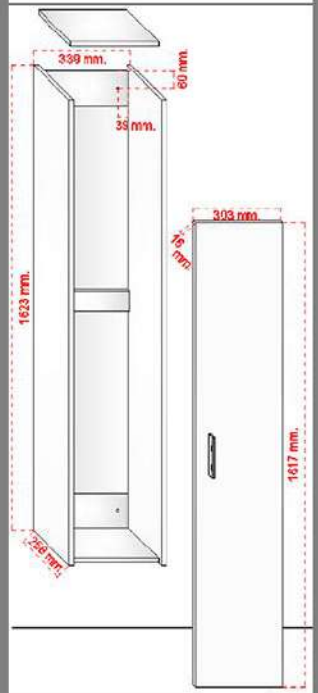
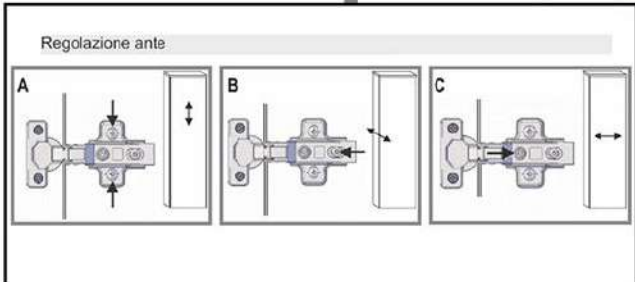
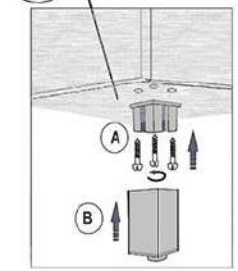

<< " POSIZIONAMENTO SOSPESO " >>

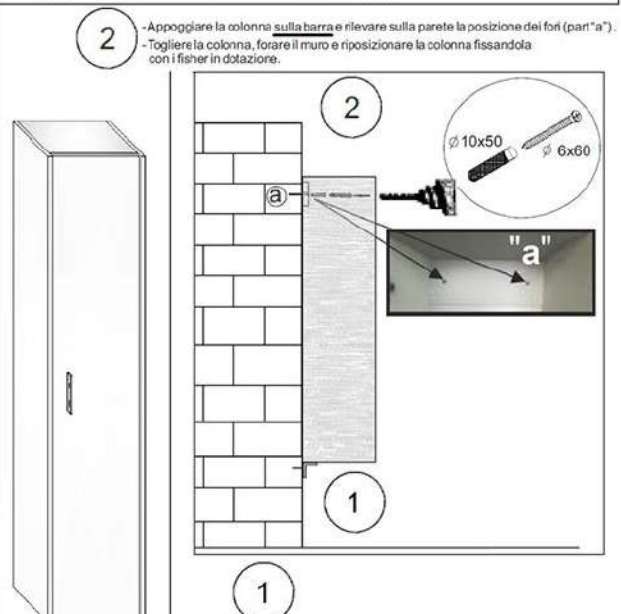

1 - Livellare e fissare la barra di supporto, nella posizione prescelta, alla parete con i 2 fisher in dotazione.

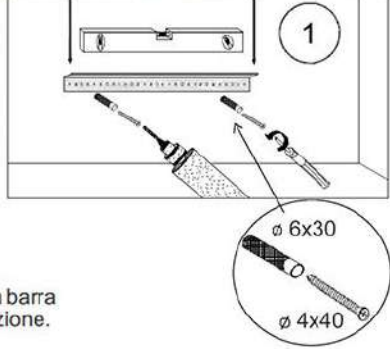
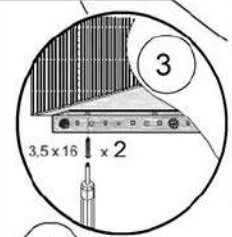

3 - Fissare la colonna alla barra tramite le 2 viti in dotazione.

