

D MAINTENANCE

CAUTION:
Always turn water OFF before removing existing or disassembling the faucet. Open faucet handle to relieve water pressure and insure that complete water shut-off has been accomplished.

To keep the surface clean and bright, please clean the faucet regularly, please abide by the following procedures:

1. Use rinsing water and soft cloth, clean bilge and bilge membrane on the surface to the best of the abilities.
2. Cleaned the residua with the following cleansers only.
 - Soft liquid cleanser.
 - Colorless glass cleanser, totally soluble powder cleanser without abrasive capability. (Mixed by instructions.)
 - No abrasive cleansers waxes
 - Never use cleanser, emery cloth or handkerchief which can rub.
 - Never use cleanser containing abrasive cleansers, ammonia, bleach, acids, waxes, alcohol, solvents or other products not recommended for chrome.
3. After cleaning, use rinsing water to flush out all cleanser immediately and drying with soft cotton cloth.
4. Carefully dismantle the aerator regularly, rinse under clean running water until any loose debris is cleared to avoid the influence to water outflow.

Prodotto importato da:
IPERCERAMICA S.p.A.
Via Pedemontana 13,
41042 Fiorano Modenese (MO) Italy
www.iperceramica.it
MADE IN P.R.C

MODEL: LUDO
Description: Shower Column

INSTALLATION MANUL

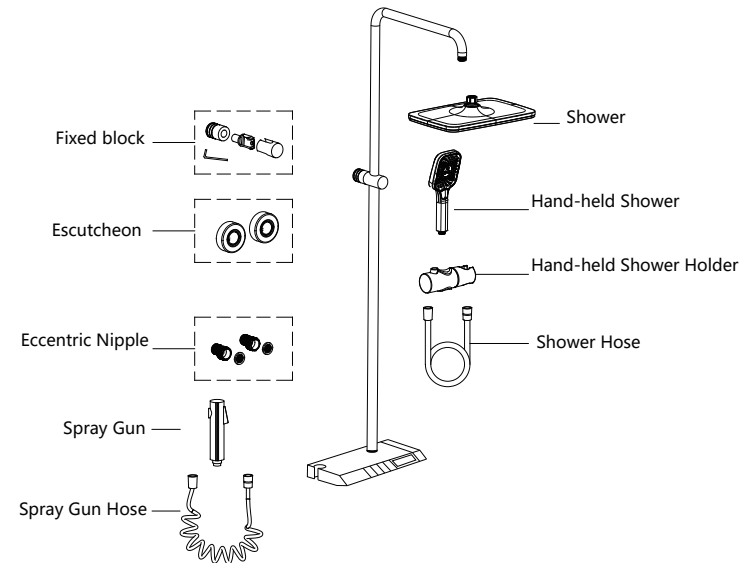

A INSTALLATION DIMENSION

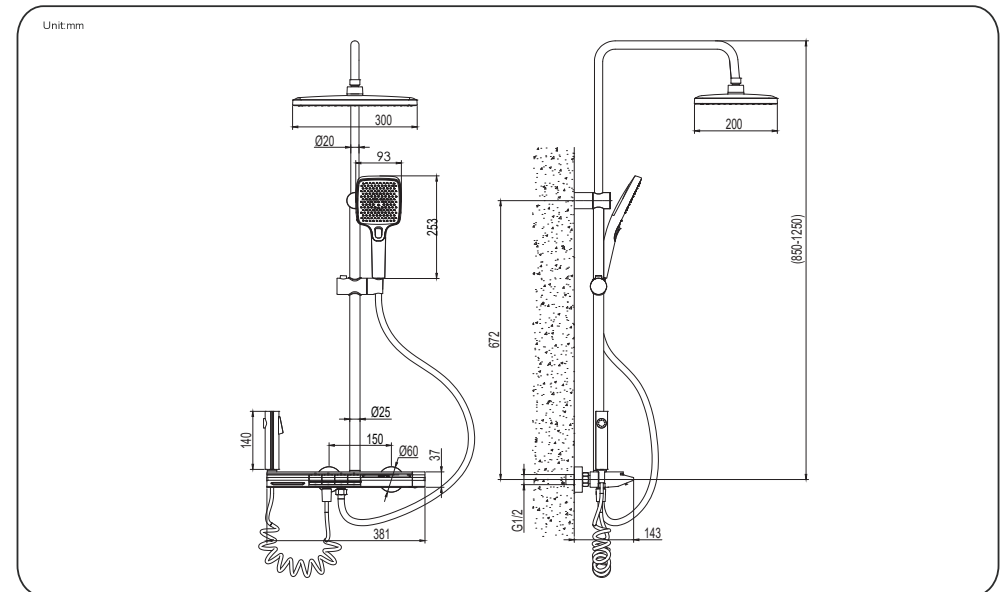

B HELPFUL TOOLS

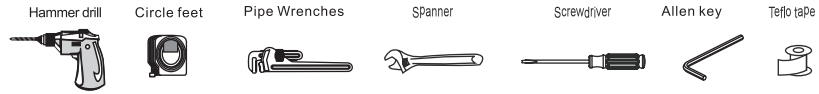

⚠ Points for attention before installation

- Before installing the new mixer, it is essential that you thoroughly flush through the supply pipes in order to remove any remaining swarf, solder or other impurities. Failure to carry out this simple procedure could cause problems or damage to the workings of the mixer.
- Work water pressure: 0.5-5kgf/cm². (Including cold and hot)
- If the pictures and statements in the 'Installation Specifications' is unconfirmed with practicality, please take practicality as standard.

C INSTALLATION STEPS

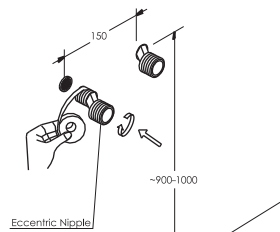

1

Apply pipe sealant to treads of eccentric nipples; connect eccentric nipples onto inlet pipes. (The measurement between two water supply is 150mm, from floor surface to water outlet is about 900-1000mm.)

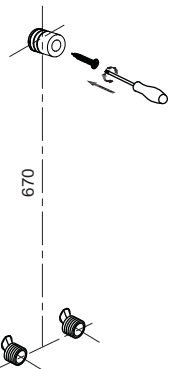

2

Refer to Essential Dimension Diagram for correct measurement.

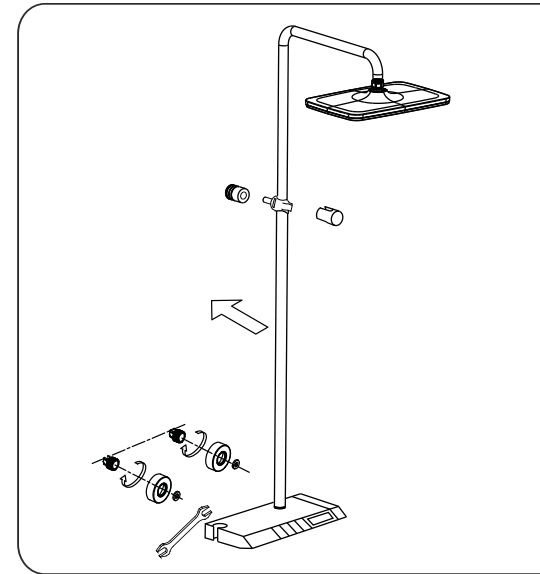

3

Assemble Faucet part together, install eccentric nipples with decorative covers; insert gasket and nut and tighten onto eccentric nipples with wrench.

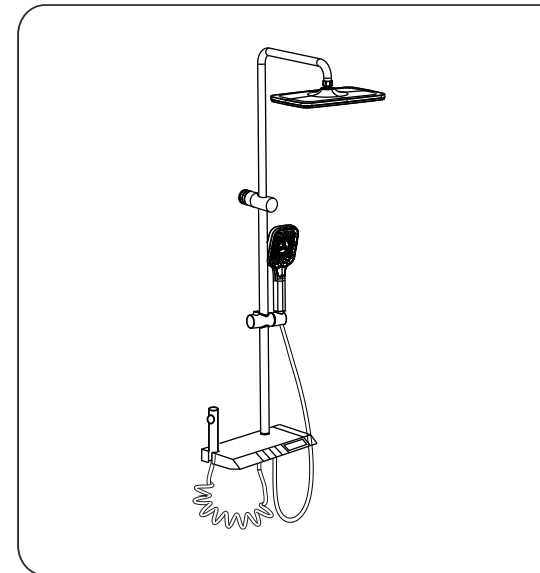

4

Connect top shower to shower pipe, then connect shower hose with faucet body and hand shower.